

TRUCKRUN



CC03 Display

USER MANUAL

CC03 3.5”TFT screen Display user's manual



A.Security Statements

For your riding safety and Enjoying use this product, please read this manual carefully and follow the instructions in the manual.。

Please pay attention on the road conditions during the cycling and don't be distracted by the instrument to avoid the occurrence of traffic accidents. If you want to check the menu carefully, stop riding and check it.

B.Product specification

B.1 Usage

This Display is used to control the e-bike drive system and display cycling data of Truckrun drive motor.

It supports customized function, support customized start-up LOGO and video.

B.2 Display menu

- a.Light
- b.Error
- c.Navigation
- d.Bluetooth
- e.Battery
- f.Battery bar
- g.Speed and Unit
- h.Speed dial scale value
- i.Dynamic velocity bar
- j.Menu level,contents:



ODO:	Total ODOmeter	Voltage:	Real time voltage
TRIP:	Single Trip Distance	Current:	Real time current
AVG:	Average cycling speed	Power:	Power
TIME:	Cycling time	L:	Current assist level
MAX:	Maximum speed		

B.3 Technical parameters

CC03			
Working Voltage	18~60(V)	Max dissipation	100(mA)
Turn-off power dissipation	5(uA)	Operate temperature(°C)	-18~60
Static power dissipation	30(mA)	Storage temperature(°C)	-30~60
		Waterproof grade	IP65

C.Operating instructions

C.1 Signs and meanings

Signs	Meaning	Signs	Meaning
	Short press (less than 0.5s)		Gear +
	Long press (more than 2s)		Gear -
	Assist walking		Lamp
	Switch on/off		Bluetooth
	Navigation mode remind		Error remind

C.2 Pre-Start-up check

Before starting the E-bike, please check the battery and speed sensor , whether they are installed in right position.

C.3 Turn on/off

Power-off state Press and hold button , Display light-up then release button, System-on; Power on state Press and hold , Display light-off, System off.

System-on state, In a time (usually 5min, The automatic shutdown time can be set manually, Setting method check **C.9.1.2**). No operation or bikeno speed, The system will be off automaticly.

C.4 Lamp on / off

Lamp-off state Press +, Display shows and release it, Lamp on meanwhile Display screen will be getting dark.

Lamp-on state Press+, Lamp sign Disappear and release it, Lamp-off, Display's brightness will be recovered.

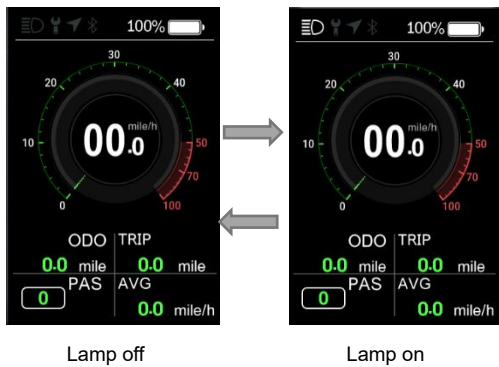

C.5 Assist walking

The bike in rest, in any gear press -, Screen shows , After 2seconds, E-bike is in assisting walking state. Walking real speed less than 2.5km/h(1.5mph) Or system doesn't sense any speed, Display shows speed 2.5km/h(1.5mph). Or E-bike speed more than 6km/h, the system will cut off assist output automaticly, recover previous state. Release - during assisting, E-bike will cut off assist output and recover previous state.

C.6 Assist gear adjustment

Press+, strengthen assist 1 gear; Press -, Weaken assist 1 gear. Display gear range 0~3/0~5/0~9 3 modes.

The relationship of 3 modes as below:

0	1	2	3	4	5	6	7	8	9
0		1		2		3		4	5
0			1		2				3

C.7 Main menu switch

On the main menu, Press to switch main menu contents, The switch orders as below:

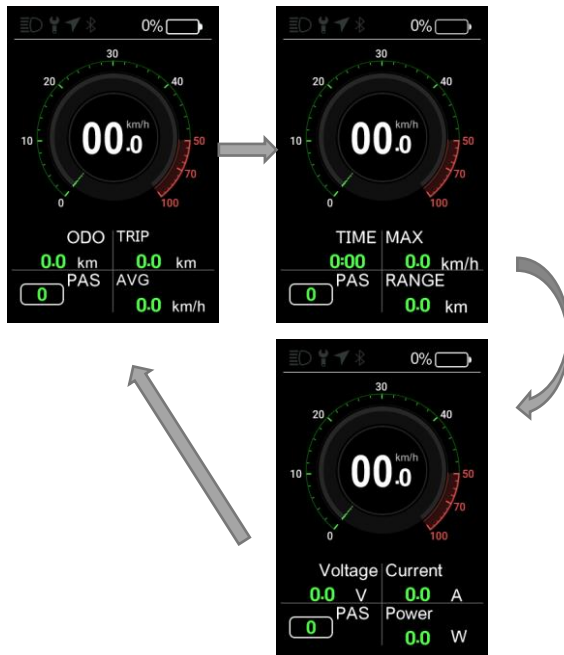

C.8 Error Display

When E-bike system has error, On the top shows , Error code is on Speed position, Error code meaning check List 1.



Error display

Error code	Reason	Error code	Reason
0x03	Brake-on(not display)	0x04	Throttle fault
0x06	UnderVoltage (not display)	0x07	Over Voltage
0x08	Motor hall fault	0x09	Motor's phase fault
0x10	Motor temperature protect	0x11	Motor's temperature fault
0x12	Current sensor fault	0x15	Controller's temperature fault
0x21	Test speed sensor fault	0x30	communication failure

C.9 Setting functions

System on and E-bikespeed is 0, Press + and - at the same time, get in setting menu, Setting options as below:

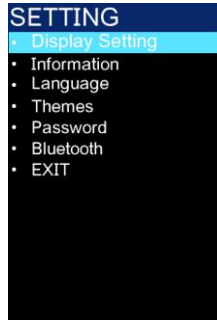

仪表设置界面

Option	Function	Option	Function
Display Setting	Set display function, such as Unit/Brightness etc	Themes	Change UI style
Information	Adjust limited speed/wheel size/system information	Password	Set start-up password
Language	Select language	Exit	Back to main menu

⌂ Press + or – **Select any one option**, Then press ⏻ get in this operation.

C.9.1 Select Display Setting

C.9.1.1 Change Unit

Press +/– Select “Unit”, Press ⏻ will see “Metric(公制)”和“Imperial(英制)”2 options, Press + or – to select it, Select and press ⏻ to change Unit, Press – **select** “back” to backup previous menu, Or press **+and –** at the same time to backup main menu.

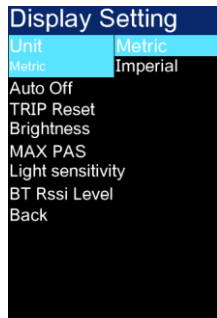

单位切换界面

C.9.1.2 Adjust power-off time automaticly

Press + or – select “Auto Off”, press ⏻ again, many time options, press + or – to select it, select and press ⏻, finish adjustment, Press – select “back” backup previous menu, Or press **+ and –** at the same time to backup the main menu.



Auto off menu

Notes: After setting Auto off , meets B.1 conditions, The system will automatically shut down when the automatic shutdown time is reached, Select“OFF”It does not shut down, that is, it will keep on when the battery power supply is normal and the system is not faulty.

C.9.1.3 Screen brightness

Press+or – Select“Brightness”, press ⏻ will see options: 10%, 30%, 50%, 75%, 100%, The higher the percentage, the brighter the screen。 Press+or – select, select and press ⏻ setting finished, press – select“back”backup previous menu, or press+ and – backup main menu。

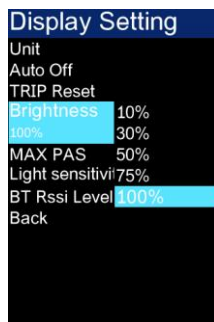

Adjust Brightness menu

C.9.1.4 Adjust max gear

Press+or – select“MAX PAS”, press ⏻ will see options: 3, 5, 9, Bigger number, higher gear。 Press +or – select, select and press ⏻ finish setting, Press – select“back”backup previous menu, press +and – at the same time to backup main menu.

Notes: The relationship of 3 modes gear ,please check C.6:

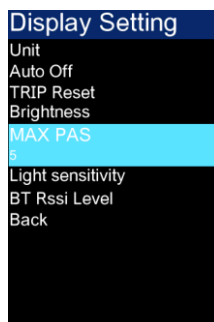

Adjust mas gear menu

C.9.1.5 Adjust Light sensitivity

Press+or – select“Light sensitivity”, press⏻ will see options: Low, Mid, High. High means the strongest. Press+or – to select it, select and press ⏻ finish setting, press – select“back”backup previous menu, Press +and-at the same time to backup main menu.

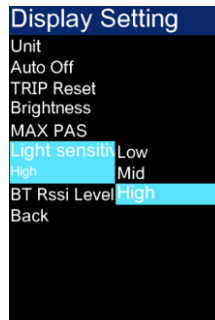

Adjust max gear

C.9.2. Select Information

C.9.2.1 Wheel size viewing and setting

Press+or – Select“Wheel Size”, Press ⏻ will see options of e-bike wheel size. Press+or – **Select** matched wheel size. Select and press ⏻ finish wheel size set, Press – select“back”backup previous menu, Press+and – at the same time to back up main menu.

Notes: Setted wheel size is different from real wheel size, display will has in-correct speed , milage will be in-correct.

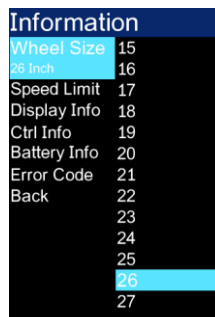

Wheel size checking and setting

C.9.2.2 Limited speed setting

Press+or – select“Speed Limit”, press⏻ will see options. Press+or – select match limited speed, select and press ⏻ finish setting, press – select“back”backup previous menu, or press+and – to backup the main menu.

Notes:

- Limited speeds means when the e-bike reaches setted speed, the system will cut off assistant output; It will be recovered while the speed is belowing setted speed.
- Set a very high limited speed, e-bike may not reach the limited speed.

The reasons as below: 1) Upload, 2) Road slope 3) Freewheel gear 4) Battery electric quantity.



Speed limit setting

C.9.2.3 Check display information

Press+ or – Select“Display Info”, Press again to check display’t hardware & software version No., Press ⏪ backup previous menu, Press +and – backup main menu.



Check display information

C.9.2.4 Check controller’s information

Press+or – Select“Ctrl Info”, Press again to check controller’s hardware&software versions. Press ⏪ backup previous menu, Press+and – at the same time to backup main menu.



Check controller's information

C.9.2.5 Check battery information

Press+or – Select“Battery Info”, Press again to check battery information, Press ⏪ backup previous menu, Press +and – at the same time to backup the main menu.

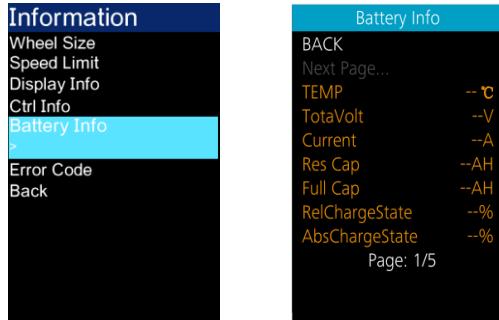

Check battery information

Name	Meaning	Name	Meaning
TEMP	Battery temperature	Cycle Times	cycle index
TotaVolt	Battery's toal Voltage	M.N.T	Max uncharge time
Current	Mainline electric current	L.N.T	Last uncharge time
Res Cap	The rest capacity	SW	Software version NO.
Full Cap	Full capacity	HW	Hardware version No.
RelChargeState	Relative capacity percentage	Cell Voltxx	The Voltage of cell's
AbsChargeState	Absulote charge percentage		

C.9.2.6 Historical fault code view

Press+or – select“Error Code”, press again to view Historical fault code, Press backup to previous menu, Press+and – at the same time to backup the main menu.

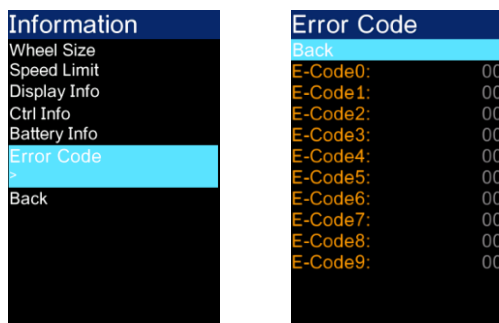

Historical fault code view

C.9.3 Select Language

Press will see languages: English Español Deutsch . Press+or – to select it, Select and press to finish setting , Press+or – select“back”to backup previous menu , Press+and – to back up main menu.

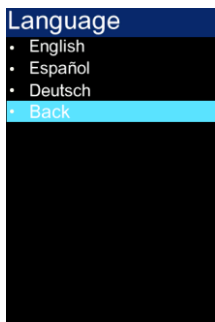

Select Language

C.9.4 Select Themes

Press check UI Options, Press+or – to select it, Select and press to finish it, Press+or – select “back” to backup previous menu, Press+and – to back up main menu.



UI change

C.9.5 Select Password



Password

Press will see password options:

“Back”-backup previous menu ; “Start Password”-start-up password function ; “Reset Password”-Reset startup password function. The images as below:

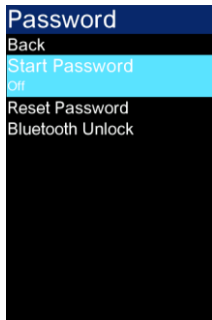

Password is off

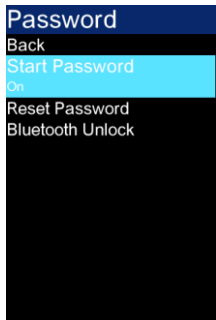

Password is on

C.9.5.1 Set startup password:

Step1. Press + or - Select "Start Password" (Start Password state is "OFF") .

Step2. Press \downarrow to reset it, Input password in dialog box, Press + or - to select numbers 0-9, select and confirm. After confirmation, the input position will be automatically switched to the next dialog box.

Step3. All set and confirm, It will show "Set Password Successfully", means set startup password successfully, after it, the initial password setting screen is displayed. The Start Password state is "On", Press + or - select "back" to backup previous menu, Press + and - to back up main menu.

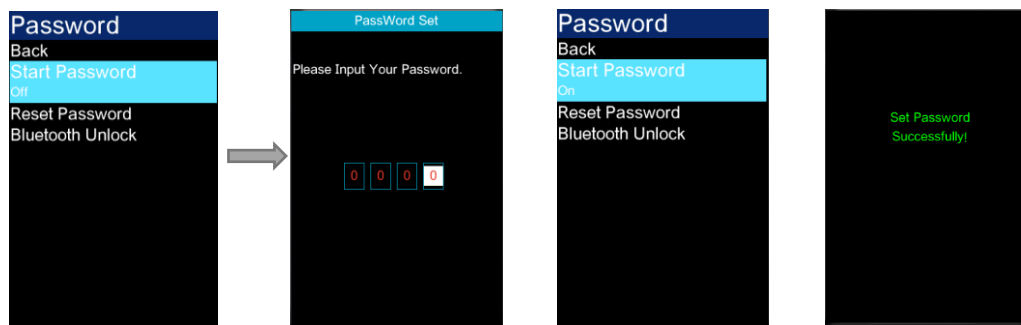

Set startup password

C.9.5.2 Cancel startup password

Step1 Press + or - Select "Start Password" (Start Password state is "On") .

Step2. Press \downarrow to confirm, Input startup password in dialog box(existed password), press + or - to select numbers 0-9, Select number and press to confirm, It will skip to next dialog box.

Step3. All selected numbers, It will show "Password Canceled Successfully", Means canceled successfully, After the password is set successfully, the initial password setting screen is displayed, Start Password state is "Off", Press + or - select "back" to backup previous menu, Press + and - to back up main menu.

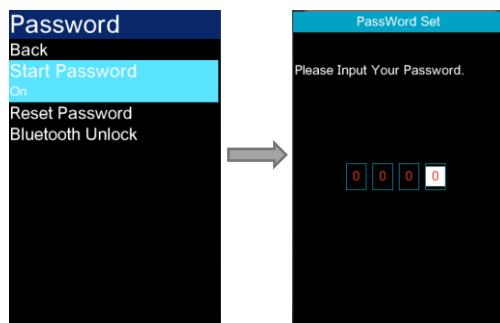

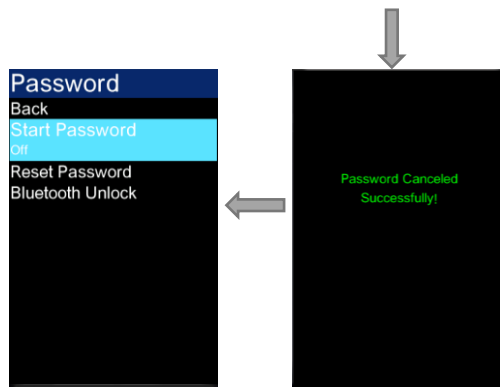

Cancel startup password

C.9.6 Reset startup password

Step1. Press + or - select "Reset Password".

Step2. Press \odot to confirm, Input startup password in the dialog box (existed password), press + or - to select numbers 0-9, selected and confirm it, it will skip to next dialog box.

Step3. After input existed password, it will show input a new password.

Step4. Input new password, it will remind you to confirm it, it needs input it again.

Step5. After a new password input, it will show "Reset Password Successfully", means reset successfully, after it, the initial password setting screen is displayed. Press + or - select "back" to backup previous menu, Press + and - to back up main menu.

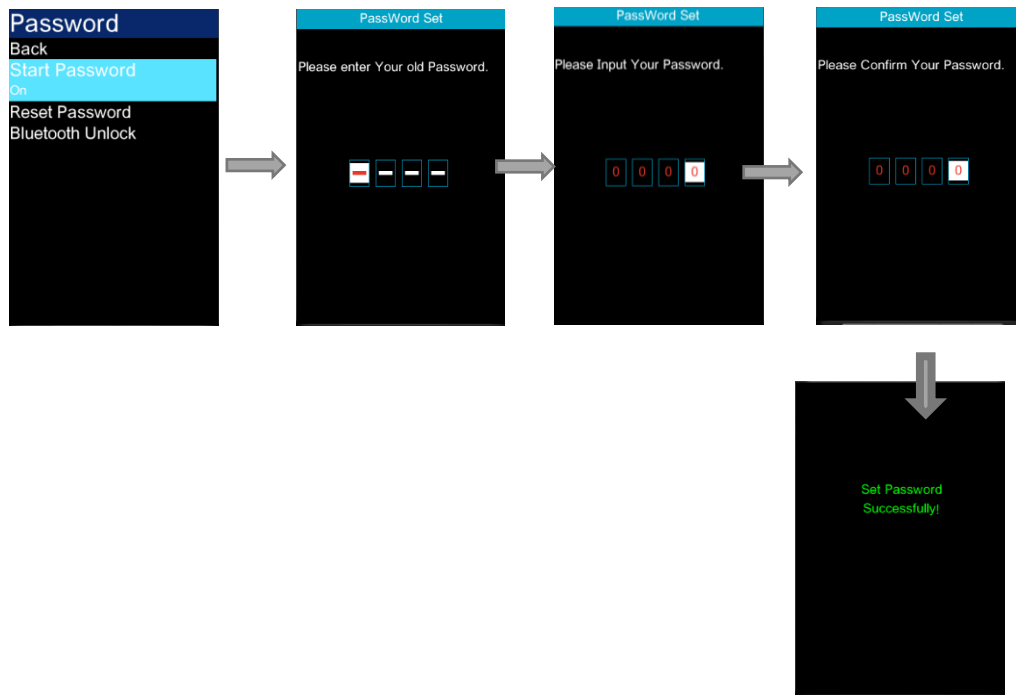

Reset startup password

D. Bluetooth Navigation

Run TRUCKRUN APP, Connect to display CC03 via bluetooth, When you run the navigation in the APP, It will show navigation menu, and the path indicator information will

be displayed in the form of arrows and numbers., app steps as below:

Step1. Turn on TRUCKRUN, connect to CC03 display, Press Navigation button to start navigate menu in app.

Step2. Press search  in navigation menu, search map.

Step3. Input destination in search box, press search to reback navigation UI.

Step4. The path information will be showed in the Navigation UI.

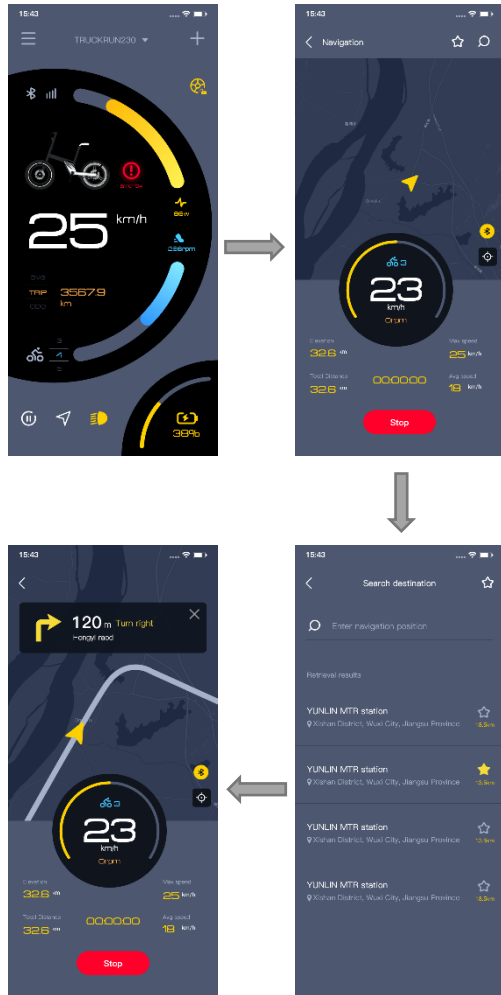

Start running navigation

It starts navigating , CC03display will show navigation UI automatically.

Arrows and numbers indicate how many meters to go straight, turn left, turn right, and display the remaining distance from the destination and other information.



Navigation UI

E.Product installation

Step1. Open the display's handle wrist, cover the handlebar in the appropriate operating position, adjust the auxiliary switch Angle, it is easier to see the switch and convenient operation when riding. (It suits for outer diameter bar 's size $\phi 22.2/\phi 31.8\text{mm}$)

Step2. Fix and tighten the matching handlebar fixed hex socket head screw with a hex wrench (Tighten torque: 0.8N.m)



* Screw locking torque, excessive torque caused by instrument damage does not belong to the scope of warranty.

Step3. PLug-in connector with integrated wiring harness as indicated.



F. Warranty :

Wuxi Truckrun Motor Co., LTD. (hereinafter referred to as "Truckrun Motor") guarantees that during the warranty period, Truckrun Motor provides warranty services to vehicle manufacturers and dealers which purchased from Truckrun Motor. If the quality problem are parts, materials and technology, Warranty services will be provided by Truckrun Motor.

Warranty Period and range

A. The warranty within 18months, from the Truckrun motor products leave factory date.

B. If the damage is caused by one of the following circumstances, it is not covered by the warranty:

B1.Damage caused by modification, neglect & improper maintenance, use for competition & commercial purposes, misuse & abuse, and traffic accidents;

B2.Damage occurred during the customer's transportation;

B3.Product damage caused by unreasonable installation, debugging or maintenance;

B4.Damage caused by non-material or technology reasons, such as the damage caused by improper usage;

B5.Damage caused by changes in the appearance and surface of the product, and such damage does not affect the function of the product;

B6.Damage caused by repair or installation by the non-designated repair center or dealer by Truckrun Motor;

Truckrun Motor has the right to choose repair or replacement, and Truckrun Motor's responsibility is limited to repair or replacement of the products. When vehicle manufacturers or dealers encounter quality problems in using or selling Truckrun Motor products, you can report the order number and product serial number of the purchase order to Truckrun after-sales Service Department. Truckrun Motor will provide free maintenance or replacement of the products that are confirmed by Truckrun Motor after-sales service Department to meet the warranty scope. Please refer to "Warranty Period and Scope" for details. If you require repair services out of the warranty period, the motor will be charged for parts, labor and transportation fee.

Please contact the vehicle manufacturer or dealer directly if you need to repair the parts of Truckrun motor which install on the vehicle. In case of any conflict between this warranty statement and the current laws of China, the laws shall prevail. Truckrun Motor reserves the right to amend the above terms without prior notice.

Wuxi Truckrun Motor Co.,Ltd